

## Table of Contents

- | Welcome
- | About the property
- | Locally owned, with national reach
- | About the Margaret River Region

## Welcome

**Thank you for your interest in 92 Ironstone Place, Margaret River.**

At First National Real Estate Margaret River, we strive to make the process of buying and selling property as simple and as straight-forward as possible.

I'm here to answer any questions you may have, so don't hesitate to get in contact.

I look forward to being of assistance in your search for your new property.

Yours sincerely,

**First National Real Estate Margaret River**

*Craig Bamford*  
*m. 0417 922 223*

## About the property



### 92 Ironstone Place, Margaret River

#### ARCHITECTURAL BUSHLAND MASTERPIECE

FROM

\$2,750,000

3 Living Areas

Ducted Cooling

Study

Ducted Heating

Solar Panels

Water Tank

Outdoor Entertaining

Shed

Workshop

Fully Fenced

Built In Robes

Stunning is how I can best describe this unique minimalistic residence on 1.42 Hec (3.50 acres). The location is idyllic, positioned equidistant between Surfers Point at Prevelly and the main street of Margaret River Township. Hidden away at the end of a long bitumen driveway, entry to the property is very scenic with large Marri Trees featuring to the left and established Peppermint Trees lining the winter creek line to the right. The brilliant design is north facing, it emphasizes space and effortlessly connects the home to the forest canopy. Boasting bold lines and precise detail throughout, the construction uses complimenting raw materials of brick, steel, timber, concrete and glass to further blend with its surroundings. The owners have created an individual residence like no other in Margaret River. Construction was completed in late 2022 with an overall footprint of 600m<sup>2</sup>, the layout is generous and uncluttered and has resulted in spacious light filled spaces throughout. The design of this solar passive stunner is timeless and in years to come will continue to stand out with its individualistic charm. It will impress the most fastidious of buyers especially those with a genuine love of architecture that delivers more with less in spades.

The main residence consists of 2 Bedrooms and 2 bathrooms including a large office which can be separated into two self-contained living areas. Under the same roofline is a 1-bedroom ancillary dwelling cleverly isolated by the spacious breezeway. All bedrooms are Kingsize, and storage is more than ample throughout. Both ensuite bathrooms include baths which offer lovely views to the bushland. The additional indoor-outdoor bathroom with two showers is perfect for beach lovers and gardeners alike and those that love to shower outside. In addition, there is a powder room and two laundries.

There is more than adequate undercover parking and storage for cars and equipment, with a fantastic freestanding multi-purpose space at the back of the property, perfectly blending in with the main residence by the use of similar building materials. The list of non-standard extras is extensive so please refer to the additional features to property attached.

The property is offered to market at offers From \$2.75m. Inspection is by appointment only. So please make a time with Craig Bamford on 0417-922 223, exclusive Property Consultant to 92 Ironstone Place in Margaret River.

## Floor Plan

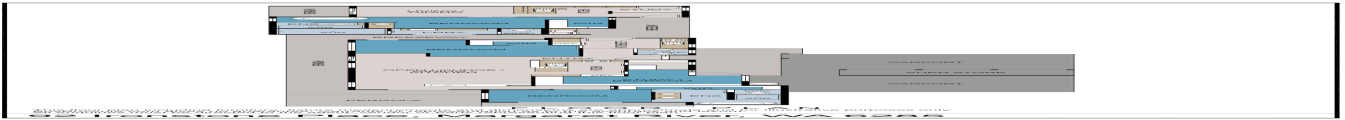

## Title Documents

**Certificate of  
Title**

**Deposited Plan  
416114**

**Document Notification  
O331433**

**Document Notification  
O331434**

**Document Notification  
O331435**

## Locally owned, with national reach

### Margaret River Real Estate First National

#### Our company

Margaret River Real Estate First National is the first choice for the most advanced real estate services. We facilitate the sale, rental and management of land, residential, lifestyle, rural, industrial and commercial property in the heart of the South West Capes of Western Australia.

If you've been waiting for the ideal time to buy, sell or lease property...it's now. Let us show you why!

...and whether you choose Margaret River Real Estate First National to **buy, sell, rent or manage** your property, you can be sure we'll offer you carefully tailored solutions, the highest level of professionalism, expert local knowledge and the most experienced, highly regarded real estate agents and property managers in Margaret River.

*Our aim is to get you better results, faster.*

#### Your agent



Craig Bamford

m. 0417 922 223

craig@margaretriverrealestate.com.au

[www.margaretriverrealestate.com.au](http://www.margaretriverrealestate.com.au)

**we put you first.**

## Margaret River WA 6285

### Suburb Snapshots

#### Houses



Median House Price  
**\$860,000**

12 months from 3-Apr-2024



Median Days on Market (House Sales)  
**49**

12 months from 3-Apr-2024



Number of Houses Sold  
**143**

12 months from 3-Apr-2024



Houses for Sale  
**42**



Interested Buyers (House)  
**2701**



Houses for Rent  
**12**

## Units



Median House Price

**\$860,000**

12 months from 3-Apr-2024



Median Days on Market (House Sales)

**49**

12 months from 3-Apr-2024



Number of Houses Sold

**143**

12 months from 3-Apr-2024



Houses for Sale

**42**



Interested Buyers (House)

**2701**



Houses for Rent

**12**



## About the Margaret River Region

### Explore our region



Margaret River is one of Western Australia's best tourist draw cards as it is world renowned for its winemaking, spectacular surf breaks and coastal scenery. Towering forests and picturesque vineyards provide scenic delight above ground whilst magnificent limestone caves form unique beauty underground. Located just 300 kilometres south of Perth, Margaret River is a holiday destination that is accessible to all and each year, some 1,500,000 overnight visitors embrace the diversity of this surfing, scenic wine growing region. The Augusta Margaret River region is enriched with wide range of cultures, characters and activities and supports a local population of approximately 15,000, making it one of the fastest growing shires in Australia.

**Cowaramup**

**Gnarabup**

**Gracetown**

**Hamelin  
Bay**

**Karridale**

**Margaret  
River**

**Prevelly**

**Rosa  
Brook**

**Witchcliffe**